

www.airblowerservices.com

1.630.372.9222

ALL STAR™

Regenerative Blowers
Vacuum Pumps

	Speed	Hz	HP	kW	SCFM	Pressure mbar	"H2O	Vacuum mbar	"H2O	Noise Level	Net Weight	
										dbA	kg	lbs
RB2-067-1	1	60	.67	.5	63	167	67	144	58	61 dbA	12	27
RB2-067-3	3	50	.4	.3	51	135	54	110	44	58 dbA	12	27

*Refer to curves below for detailed performance data. Data subject to change without notice. Actual performance may vary by ±10%.

STANDARD FEATURES

- Housing - Aluminum
- Impeller - Aluminum, dynamically balanced
- Direct drive impeller
- Shock absorbing mounting base
- Quiet operation - below OSHA limits
- Inlet & outlet silencers included
- Motor shaft seal standard
- IP 54 TEFC 2 pole squirrel cage ac motor
- 40 Deg C ambient
- Class H insulation 1.15 service factor
- Performance tested ANSI/AMCA210-85
- Voltage
 - 1 = 1/60/50/115/230
 - 2 = 1/60/50/230
 - 3 = 3/60/208-230/460 3/50/220/380

3/60/208-230/460 & 3/50/220/380

RB2-067-3 replaces HB-229

1/60/50/115/230

RB2-067-1 replaces HB-229-1

REQUIRED ACCESSORIES

Note: To obtain warranty coverage on the blower, a relief valve and filter are required.

Pressure Relief Valve RV-01
Pressure Relief Valve RVA-01

Vacuum Relief Valve RV-01
Vacuum Relief Valve RVA-01

Pressure Intake Air Filter F19P-125
Vacuum Air Filter CSL-849-125HC



TECHNICAL DATA

[Available online www.all-star-usa.com]

- Performance Temperature Rise Curves
- AutoCad files
- Parts List
- Full amperage



RoHS
Compliant

PRESSURE DATA CURVES ±10%

[See reverse side for Vacuum Curves]

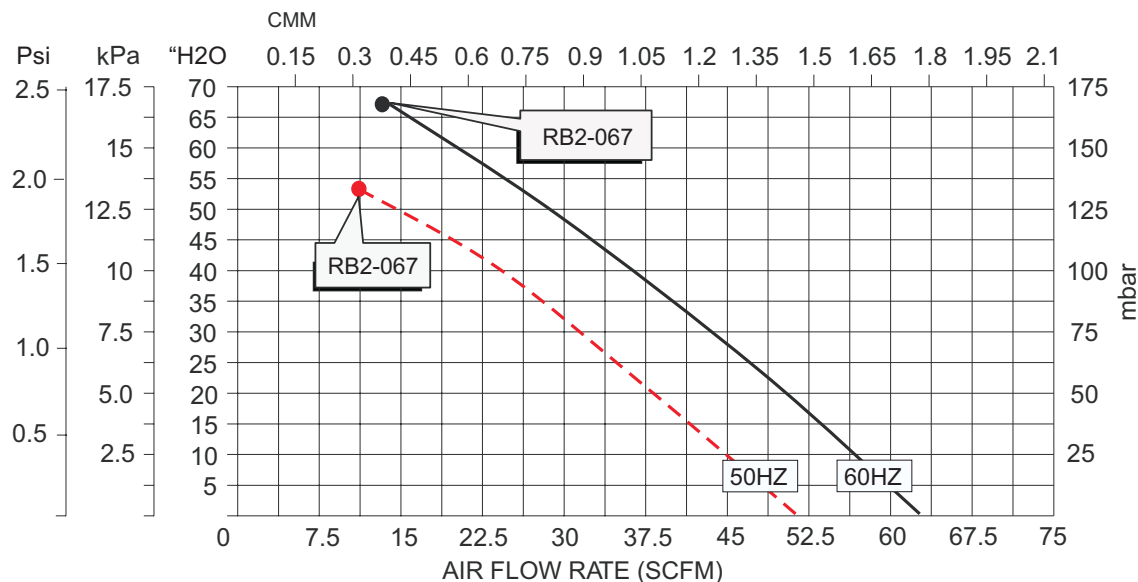

1.630.372.9222

ALL STAR™
Regenerative Blowers
Vacuum Pumps

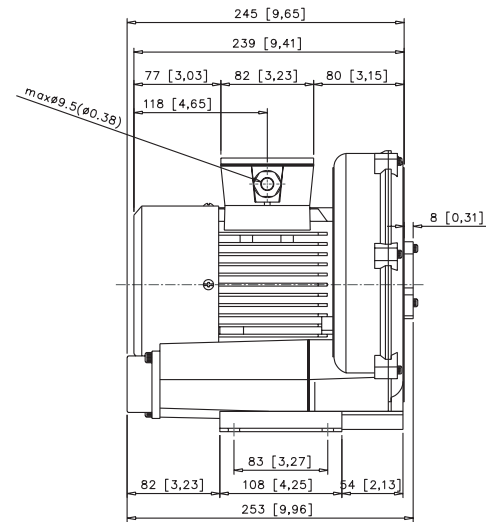
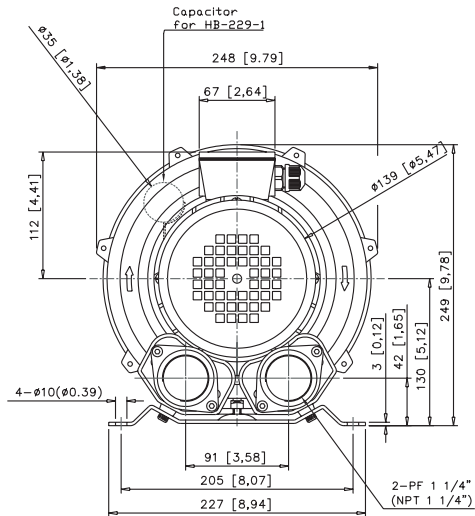
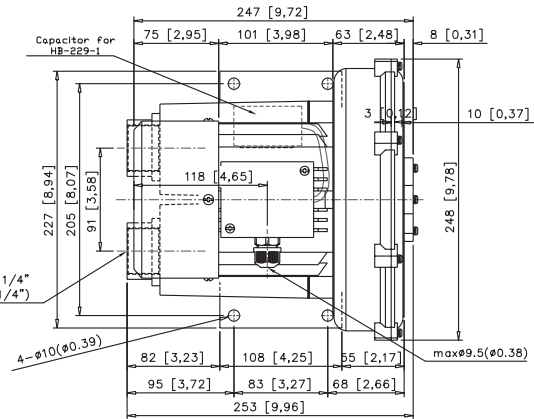
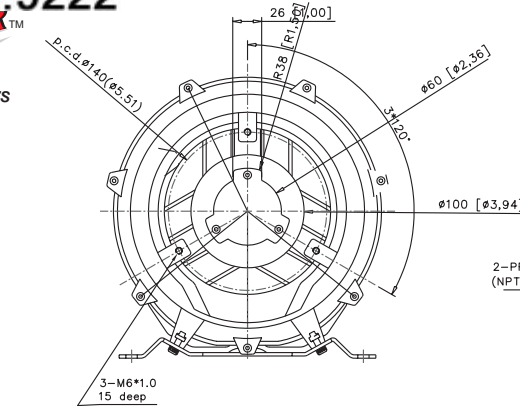

VACUUM DATA CURVES ±10%

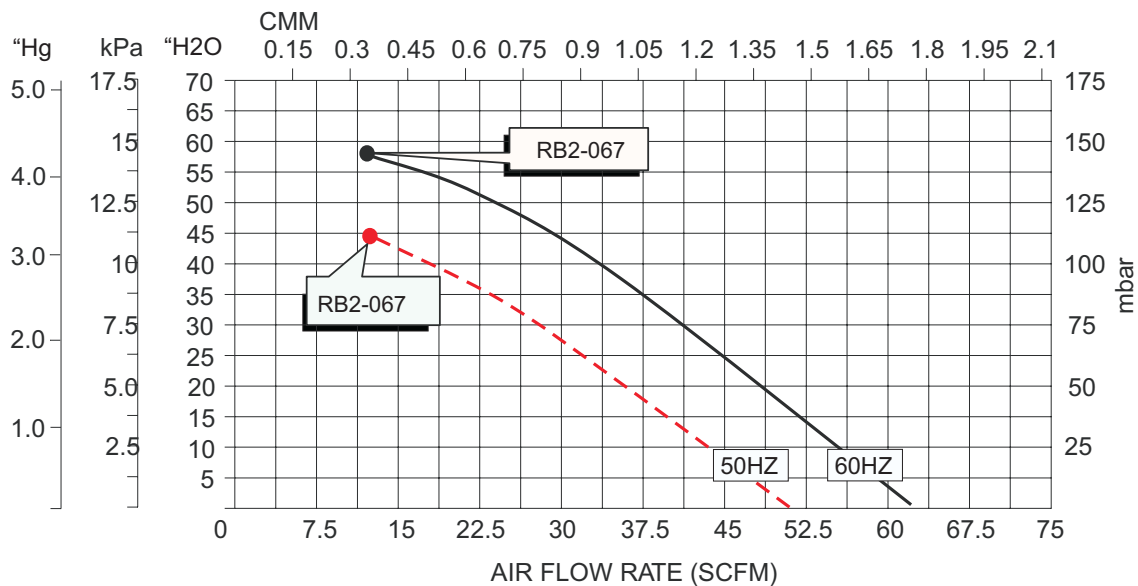

Air

Blower Services Inc.

www.airblowerservices.com

1.630.372.9222

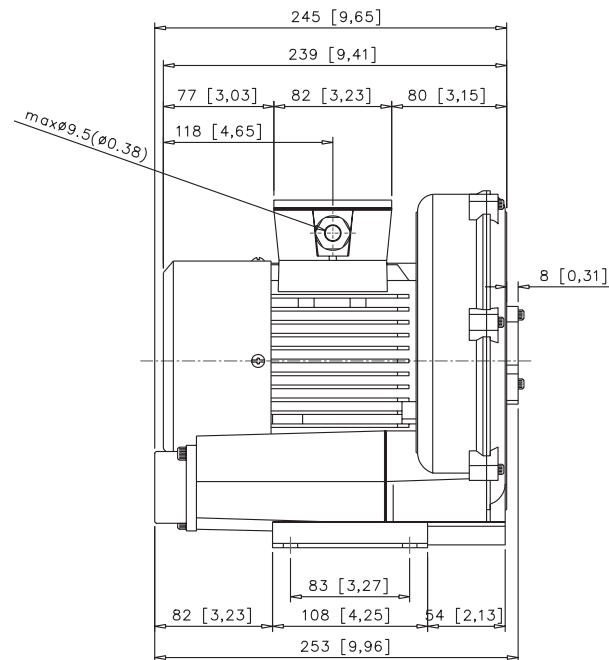
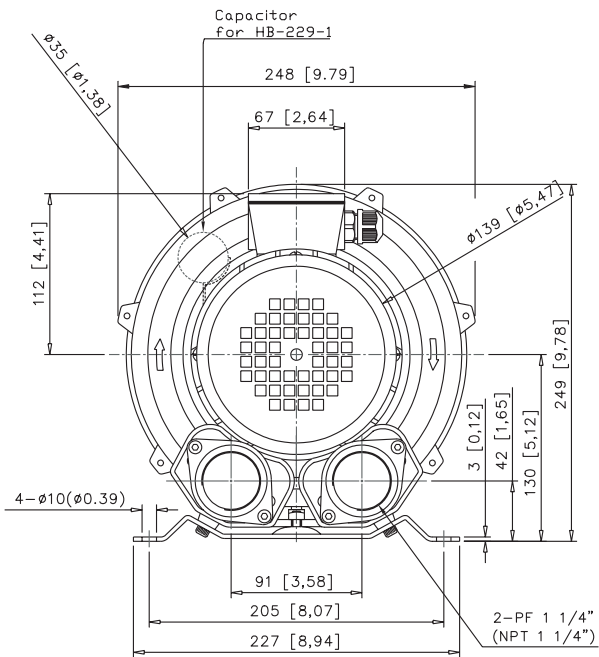
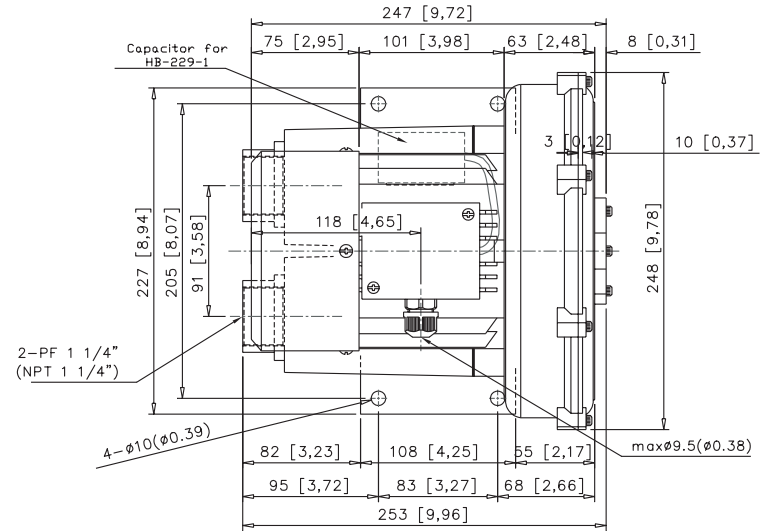
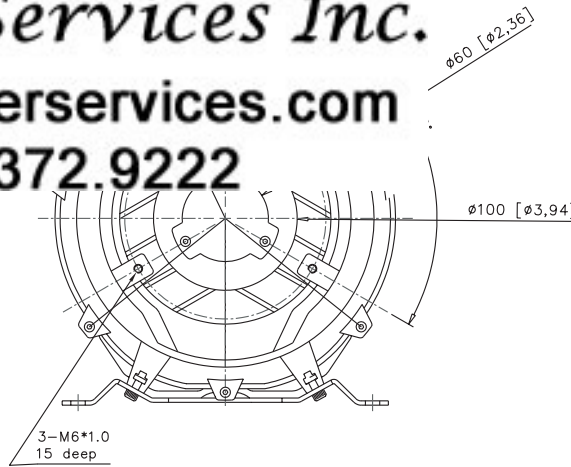

ALL-STAR PRODUCTS INC
Cleveland Ohio Memphis Tennessee

REGENERATIVE BLOWER
Model RB2 Series

December 30, 2006

B2 Series - Pressure - Single Phase

60Hz

The technical data is based on 1 bar (abs.) free atmosphere and 20°C with Inlet air density 1.2kg/m³, ±10 %variance.

November 2006

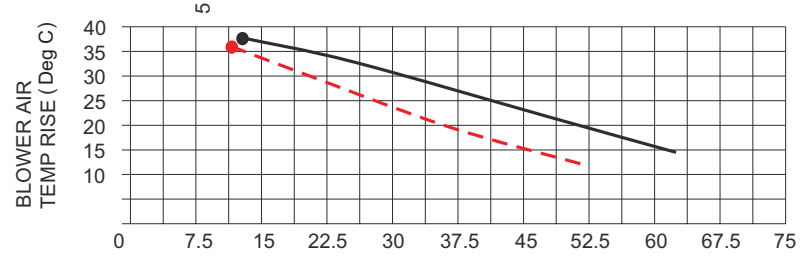
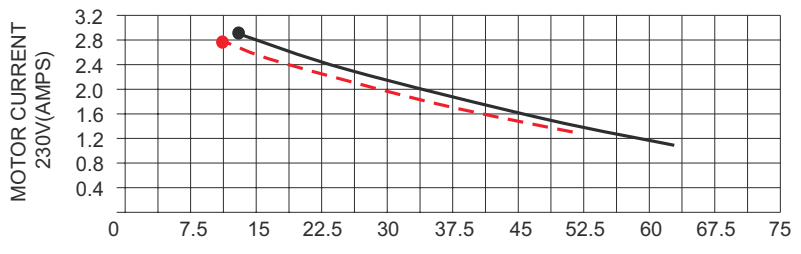
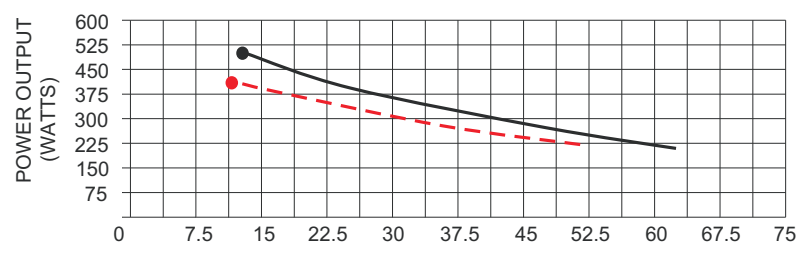
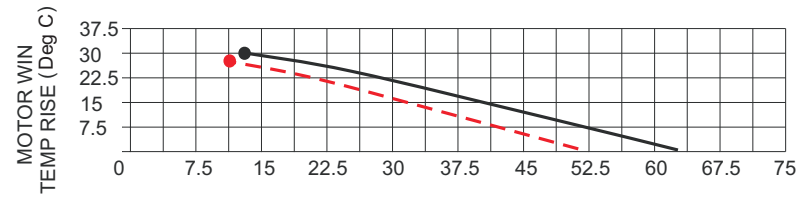
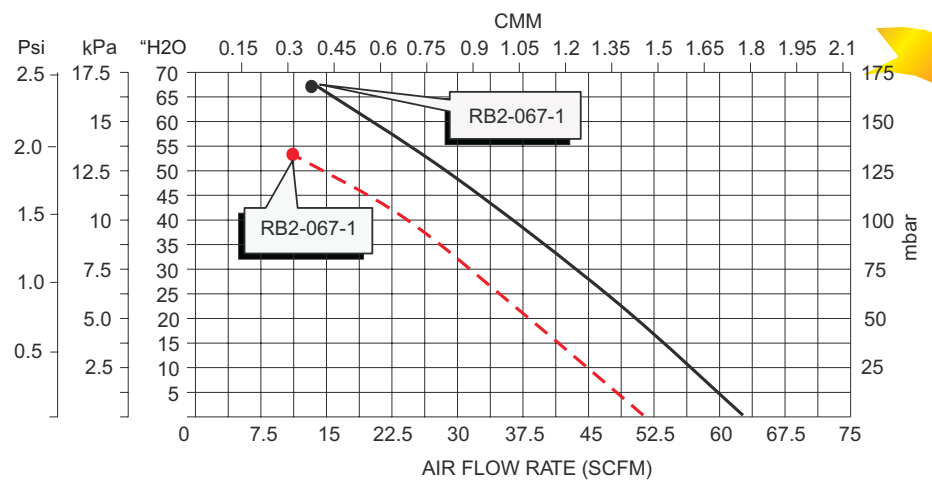

B2 Series - Vacuum - Single Phase

60Hz

The technical data is based on 1 bar (abs.) free atmosphere and 20°C with Inlet air density 1.2kg/m³, ±10 %variance.

November 2006

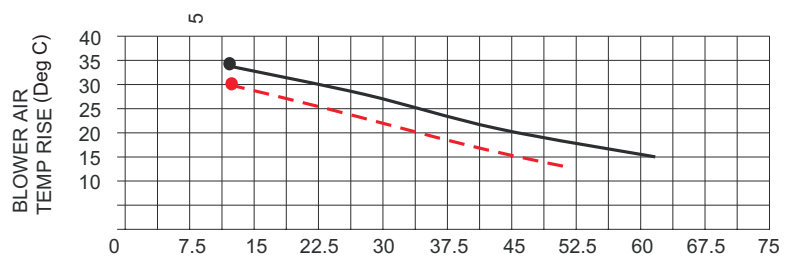
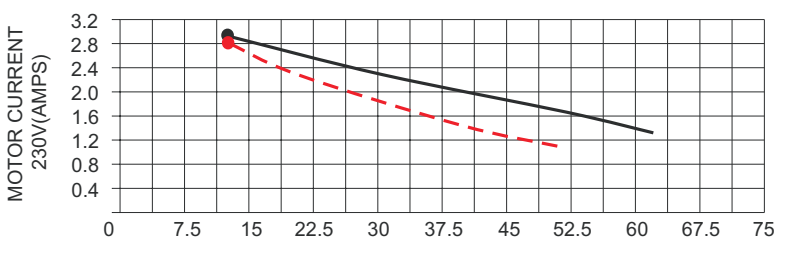
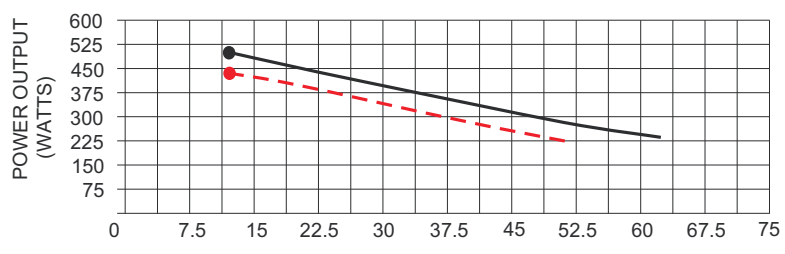
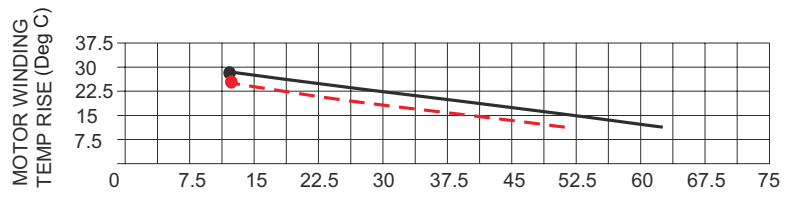
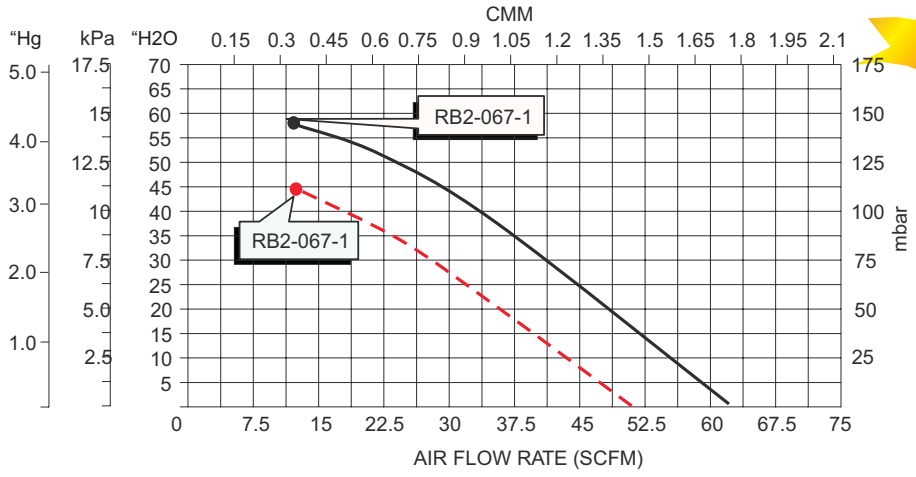

B2 Series - Pressure - Three Phase

60Hz

The technical data is based on 1 bar (abs.) free atmosphere and 20°C with Inlet air density 1.2kg/m³, ±10 %variance.

November 2006

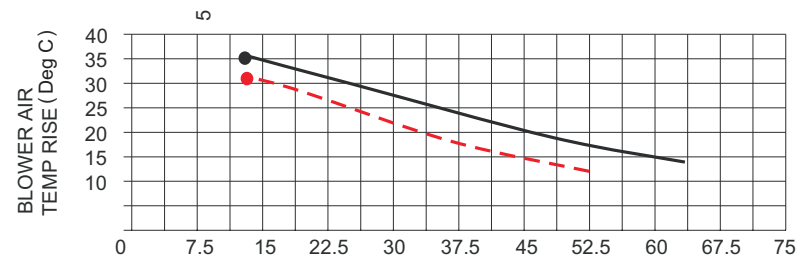
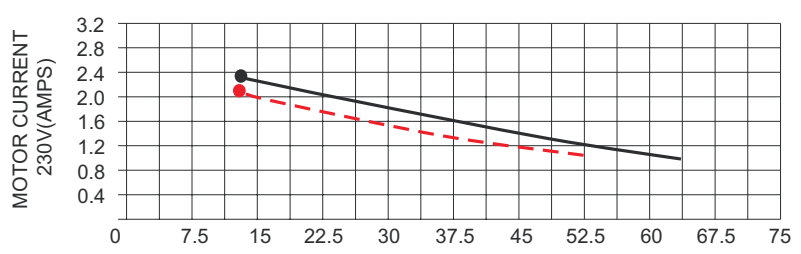
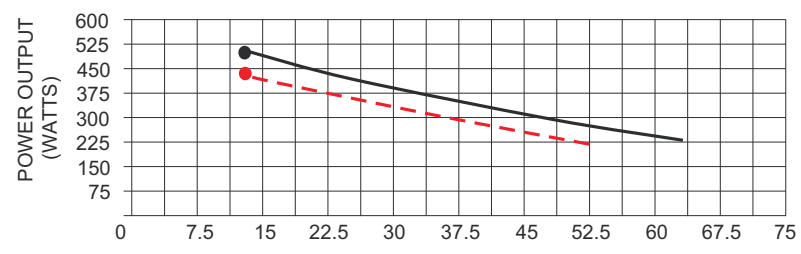
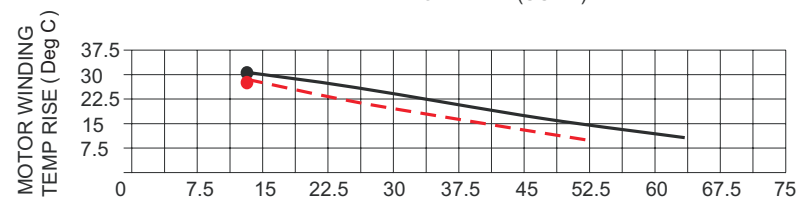
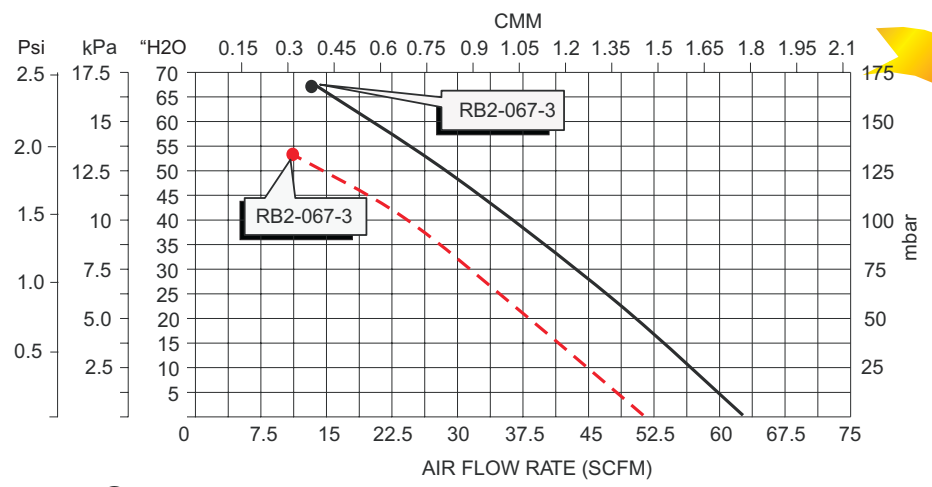

B2 Series - Vacuum - Three Phase

60Hz

The technical data is based on 1 bar (abs.) free atmosphere and 20°C with Inlet air density 1.2kg/m³, ±10 %variance.

November 2006

